



WELDING AND CLAMPING SYSTEMS

**NEW**

PROFESSIONAL S4 SYSTEM 22



SYSTEM  
**22**

# NEW



## MATERIAL THICKNESS

approx. 17 – 19 mm

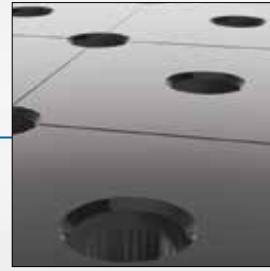

## MATERIAL

Specific base material S355J2+N (St 52/3)  
(like Professional S4 welding tables System 16 and 28)



## EDGES

Radius 3 / 6 mm on the table edges



## TABLE LEGS

- Stable square pipe 80x80 mm
- Base plate Ø 80 mm
- Leg 50 mm vernier adjustment
- Bearing load 1.000 kg per leg  
(Data only for Leg standard equipment)

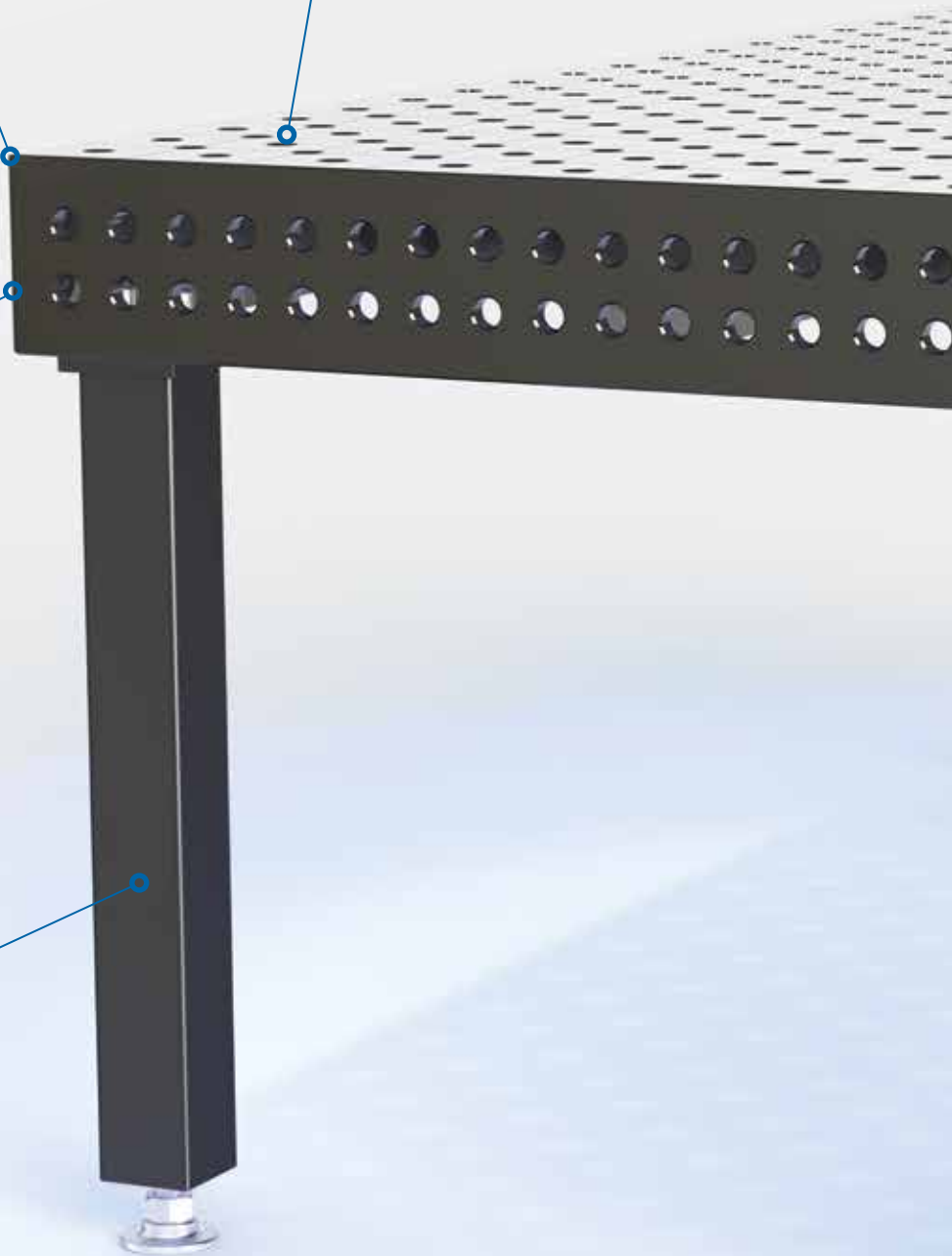

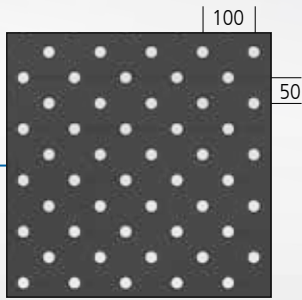

**DIAGONAL GRID**

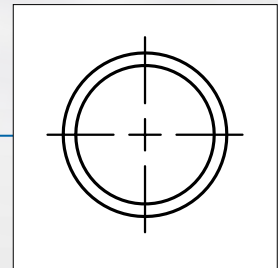

**BORE HOLE Ø 22 MM**

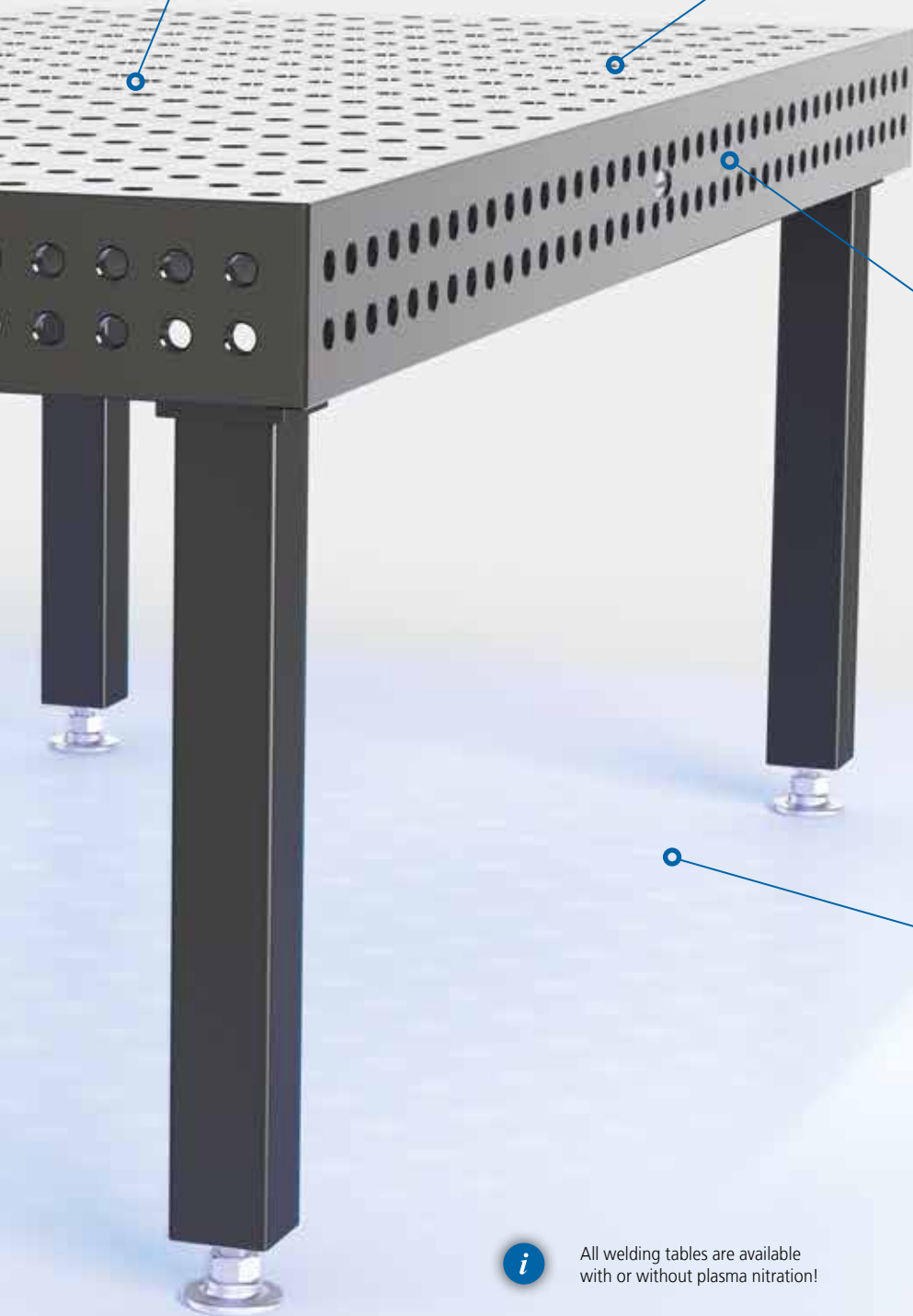

**TABLE SIDE PANEL**

- 150 mm high
- Borehole spacing 50 mm

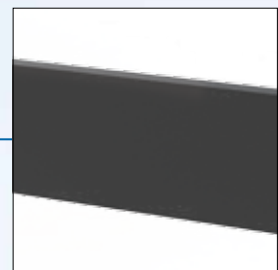

**RIBBING**

Construction reinforced with ribbing



All welding tables are available with or without plasma nitration!

DELIVERY FROM 01.02.2016



	Clamp	Clamp	Prism	Bolt	Stop	Stop	Square	Square	Square
Material	burnished	burnished	burnished	burnished	burnished	burnished	burnished	burnished	burnished
Item No.	2-220610	2-220630	2-220645.1	2-220510	2-220410	2-220420	2-220110	2-220152	2-220162
<b>2-223100</b>	4 x		4 x	16 x	6 x	6 x	4 x		
<b>2-223200</b>	8 x	4 x	8 x	24 x	8 x	8 x	8 x	2 x	2 x
<b>2-223300</b>	12 x	6 x	8 x	36 x	12 x	12 x	12 x	4 x	4 x

All Sets incl. Accessories-Set 223999: 1 x 220402, 1 x 220852, 1 x 220820, 1 x 000942, 1 x 000911, 1 x 000921

## SYSTEM 22

Without  
Plasma nitration <sup>1</sup>

With  
Plasma nitration <sup>2</sup>

Table size	inclusive			
1,0 m x 1,0 m	4 Legs	○	2-220010	● 2-220010.P
Item No.	(approx. 317 kg)			
1,5 m x 1,0 m	4 Legs	○	2-220035	● 2-220035.P
Item No.	(approx. 434 kg)			
2,0 m x 1,0 m	4 Legs	○	2-220020	● 2-220020.P
Item No.	(approx. 555 kg)			
2,4 m x 1,2 m	6 Legs	○	2-220030	● 2-220030.P
Item No.	(approx. 753 kg)			
3,0 m x 1,5 m	6 Legs	○	2-220040	● 2-220040.P
Item No.	(approx. 1098 kg)			

<sup>1</sup> No hardened or coated surface against rust and welding spatters. Protection against welding spatters by anti-spatter spray only.

● Item is produced to stock  
○ Item is produced on order, partially in stock

<sup>2</sup> Surface hardened and protected against welding spatters.

## MORE ITEMS



Combination Clamping Bolt 28 -> 22



Connecting Bolt



Connecting Bolt 28 -> 22



Connecting Bolt 22 -> 16

Material	burnished	burnished	burnished	burnished
Item No.	2-002822	2-220560	2-028022	2-022016

All prices on request!

Please note that all prices do not include sales tax and costs for packaging and freight. Errors and technical improvement may change these data. Our General Terms and Conditions apply. Errors and price changes reserved.

More articles can be found gradually on our website [www.siegmund.com](http://www.siegmund.com)

