

**NEW**

## Small Type Arc Welding Robots **TS Series**

### The Arc Welding Robot System **TAWERS**

Payload:  
**8 kg**  
TS-800/950



### Succeed TAWERS' welding performance

#### ● Various welding styles

Super Active TAWERS / TAWERS-TIG / TAWERS or others

【TW axis: Hollow arm】

Torch type selectable between through-arm and external



【Separate wire feeder】  
Free layout

### Improve small work productivity

#### ● Space saving

48 % smaller footprint

(example of one customer, compared with our TM-1100)

Floor/Wall/Ceiling mount

(Ceiling mount type is special specification.)

#### ● High speed despite 8 kg payload

Maximum motion speed: 540°/s

(average for all axes)

# Dimensions & Working Envelope (Unit: mm) For working envelope of point O, consult us.

## Short Type TS-800

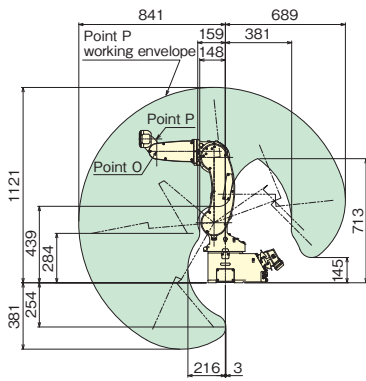

## Short Type TS-950

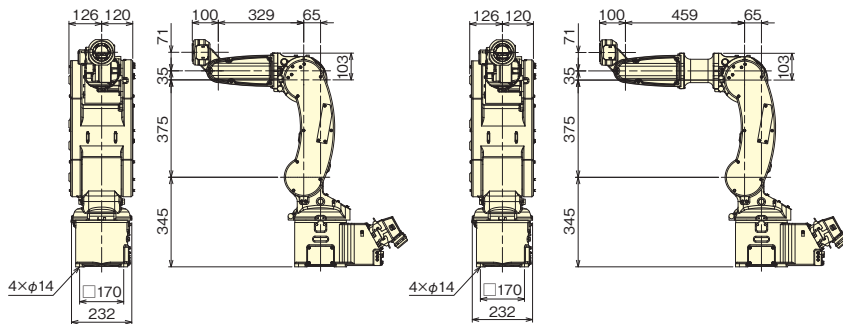
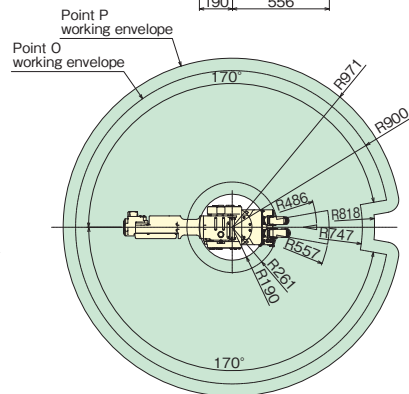
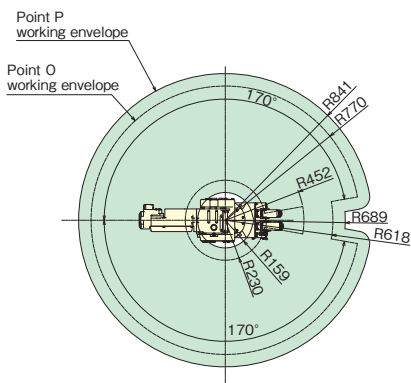
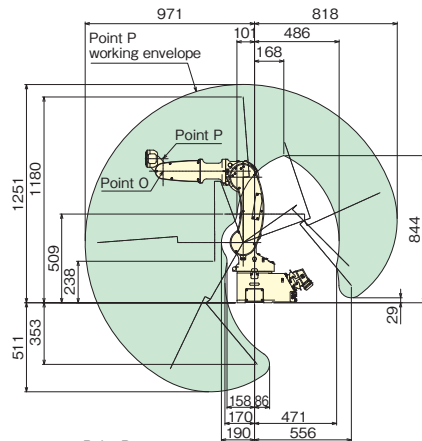

## Controller

(WGIII and WGHIII include welding power unit.)

WGIII

WGHIII

(mm)

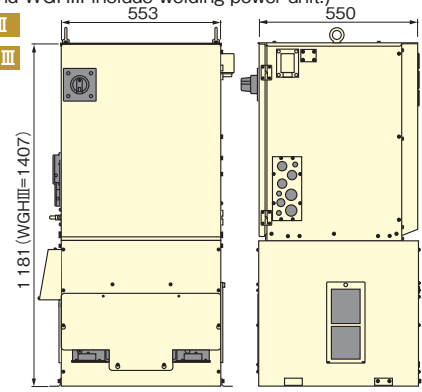

GIII

(mm)

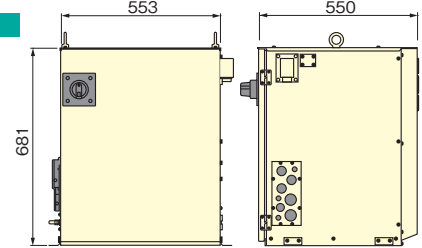

Combination with WGHIII or GIII is built to order.

## Manipulator General Specifications

Model	TS-800	TS-950
Type	Short arm	Short arm
Structure	6 axis articulated	
Payload	8 kg	
Maximum Reach	841 mm	971 mm
Minimum Reach	159 mm	190 mm
Working Range	682 mm	781 mm
Max. Motion Speed	RT (Rotating Trunk)	326°/s
	UA (Upper Arm)	326°/s
	FA (Forearm)	510°/s
	RW (Rotating Wrist)	518°/s
	BW (Bending Wrist)	518°/s
TW (Twisting Wrist)	1 040°/s	
Position Repeatability	±0.05 mm	
Motors	Total Power	2 100 W
	Brakes	All axes
Mounting	Floor/Ceiling*1/Wall*2	
Weight	55 kg	56 kg

\*1: Ceiling mount type is factory optional.

\*2: Setting by service personnel is necessary.

Working range of RT axis is limited.

**⚠ Safety precautions** ● Before attempting to use any welding product always read the manual to ensure correct use.

**Panasonic Corporation**  
 Process Automation Business Division, Business Innovation Center  
 1-1,3-chome,Inazu-cho,Toyonaka,OSAKA 561-0854 Japan  
 TEL: 81-6-6866-8505 FAX: 81-6-6866-0709

**Panasonic Smart Factory Solutions Co., Ltd.**  
 Thermal Fabrication System Business Unit  
<http://www.panasonic.com/jp/company/psfs.html>

**Panasonic Welding Systems (Tangshan) Co., Ltd.**  
 No.9 Qingnan Rd.,Tangshan New & Hi-Tech Industrial Park,  
 063020 Hebei, China  
 TEL:86-315-320-6060 FAX:86-315-320-6070  
<http://pwst.panasonic.cn>

**Panasonic Welding Systems India**  
 Industrial Plot No.1, Village Bid Dadri, Jhajjar - 124103,  
 Haryana, India

**Panasonic Factory Solutions Company of America**  
 1701 Golf Road, Suite 3-1200 Rolling Meadows, IL 60008 USA  
 TEL:1-847-637-9700 FAX:1-847-637-9601  
<http://www.panasonicca.com>

**Panasonic Automotive & Industrial Systems Europe GmbH**  
 Jagenbergstr 11a, D-41468 Neuss Germany  
 TEL:49-2131-60899-0 FAX:49-2131-60899-200  
<http://eu.industrial.panasonic.com/>

**Panasonic Industrial Devices Sales (Thailand) Co., Ltd.**  
 252/133 Muang Thai-Phatra Complex Building, 31st Fl.  
 Rachadaphisek Rd., Huaykwang, Bangkok 10320 Thailand  
 TEL:662-693-3421 FAX:662-693-3427

● Specifications are subject to change without notice.  
 ● Windows is a registered trademark of Microsoft Corporation in the United States and other countries.

Catalog No.

IRTAW-TSWGIII

Printed in Japan [2017.9] 1-003P